



**Addendum No. 1
Invitation to Tender ES-18-13
Shoreline Stabilization & Drainage Works - Harold Mann Reg. Park**

The addendum is being issued prior to the closing of the ITT to provide further information, make changes to, or to clarify the Contract Documents and is to be read, interpreted and coordinated with all other parts of the Contract Documents. In the case of a conflict with the balance of the documents, this Addendum shall govern. **Tenderers shall attach a signed copy of this addendum to their Invitation to Tender.** This addendum shall form part of the Contract Documents.

Replace Appendix A, Site Layout and Design Drawings with corrected Harold Mann Site Layout and Site Drawings.

Date: August 28, 2018

Addendum No. 1 Received.

Signature of Proponent

Name of Proponent

Inquiries relating to this RFP may be directed to:

Technical Inquiries:

Bryan Boyes
Utilities Leader
Regional District of Fraser-Fort George
155 George Street
Prince George BC V2L 1P8
Telephone: 250-960-4400 Fax: 250-562-8676
Email: bboyes@rdffg.bc.ca

General Inquiries:

Petra Wildauer
General Manager of Environmental Services
Regional District of Fraser-Fort George
155 George Street
Prince George, BC V2L 1P8
Phone: 250-960-4400 / Fax: 250-526-8676
Email: pwildauer@rdffg.bc.ca

SURVEY CONTROL TABLE				
POINT NAME	NORTHING	EASTING	ELEVATION	DESCRIPTION
77C434	5994787.247	543897.558	603.998	FMON
1212	5994787.465	543891.678	604.130	SPK
1456	5994858.675	544069.101	609.411	SPK
1476	5994665.748	543724.991	599.753	SPK

PLAN A-2787

DL7945

LOT 1

REM

DL7946

PLAN

25033

LOT 2

LEGEND

SURVEY		SITE FEATURES	
FOUND	SET	EXISTING	
●	○	○	CONIFEROUS TREE
▲	▲	▲	POST MOUNTED SIGN
▲	▲	▲	SIGN ON TWO POSTS
▲	▲	▲	TEST PIT
—	—	—	PAVED ROAD
—	—	—	UNPAVED ROAD
—	—	—	TOP OF BANK
—	—	—	BOTTOM OF BANK
—	—	—	WOOD FENCE

NOTES

- SURVEYED BY McELHANNEY CONSULTING SERVICES Ltd. (J. GAYOWSKI & M. BOWE) September 14, 2016
- COORDINATES ARE GRID, BASED ON UTM ZONE 10, NAD83 (CSRS) 2002.0 PROCESSED USING NATURAL RESOURCES CANADA'S PRECISE POINT POSITIONING SERVICE. COMBINED SCALE FACTOR AT POINT 1476 IS 0.99953147
- ELEVATIONS ARE RELATIVE TO CGVD28 (HT 2.0)
- THE PROPERTY BOUNDARIES SHOWN ARE COMPILED FROM LEGAL PLANS AND A SUFFICIENT NUMBER OF FIELD TIES TO IRON POSTS. THEY SHOULD BE USED ACCORDINGLY.
- NO UNDERGROUND UTILITIES WERE LOCATED FOR THIS SURVEY.
- CONTOUR INTERVAL IS 1m

ROAD PLAN EPP43074

TO GISCOMBE

UPPER FRASER ROAD

GRAVEL PARKING

HAROLD MANN REG. PARK

(ATTENTION ALL VISITORS)

SERVICE BOX

GATE

(NO CAMPING)

EAGLET LAKE FISHERIES MGMT

BUILDING

16-1

16-2

EAGLET LAKE

RECYCLE BIN

STONE STEPS

LOG RAIL FENCE

MEMORIAL STONE

GARBAGE BIN

WOOD STEPS

PIT TOILETS

BUILDINGS

GARBAGE BIN

NO LIFEGUARD

CULVERT INLET NOT LOCATED

THIS DRAWING AND DESIGN IS THE PROPERTY OF McELHANNEY CONSULTING SERVICES LTD. (McELHANNEY) AND SHALL NOT BE USED, REUSED OR REPRODUCED WITHOUT THE CONSENT OF McELHANNEY. McELHANNEY WILL NOT BE HELD RESPONSIBLE FOR THE IMPROPER OR UNAUTHORIZED USE OF THIS DRAWING AND DESIGN. THIS DRAWING AND DESIGN HAS BEEN PREPARED FOR THE CLIENT IDENTIFIED, TO MEET THE STANDARDS AND REQUIREMENTS OF THE APPLICABLE PUBLIC AGENCIES AT THE TIME OF PREPARATION. McELHANNEY, ITS EMPLOYEES, SUBCONSULTANTS AND AGENTS WILL NOT BE LIABLE FOR ANY LOSSES OR OTHER CONSEQUENCES RESULTING FROM THE USE OR RELIANCE UPON, OR ANY CHANGES MADE TO, THIS DRAWING BY ANY THIRD PARTY, INCLUDING CONTRACTORS, SUPPLIERS, CONSULTANTS AND STAKEHOLDERS, OR THEIR EMPLOYEES OR AGENTS, WITHOUT McELHANNEY'S PRIOR WRITTEN CONSENT. INFORMATION ON EXISTING UNDERGROUND FACILITIES MAY NOT BE COMPLETE OR ACCURATE. McELHANNEY, ITS EMPLOYEES AND DIRECTORS ARE NOT RESPONSIBLE NOR LIABLE FOR THE LOCATION OF ANY UNDERGROUND CONDUITS, PIPES, CABLES OR OTHER FACILITIES WHETHER SHOWN OR OMITTED FROM THIS PLAN. PRIOR TO CONSTRUCTION CONTRACTOR SHALL EXPOSE LOCATIONS OF ALL EXISTING FACILITIES BY HAND DIGGING OR HYDROVAC AND ADVISE THE ENGINEER OF POTENTIAL CONFLICTS.

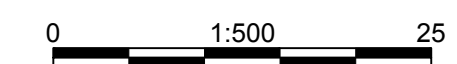

ORIGINAL DWG SIZE: ANSI D (22" x 34")



Suite 12
556 North Nechako Road
Prince George BC
Canada V2K 1A1
Tel 250 561 2229

Approved Sealed

REGIONAL DISTRICT OF FRASER - FORT GEORGE
155 GEORGE STREET, PRINCE GEORGE, BC, V2L 1P8
HAROLD MANN REGIONAL PARK
SITE SURVEY
PLAN - EXISTING CONDITION

Drawing No.	101
Project Number	2341-02214-00
Rev.	0

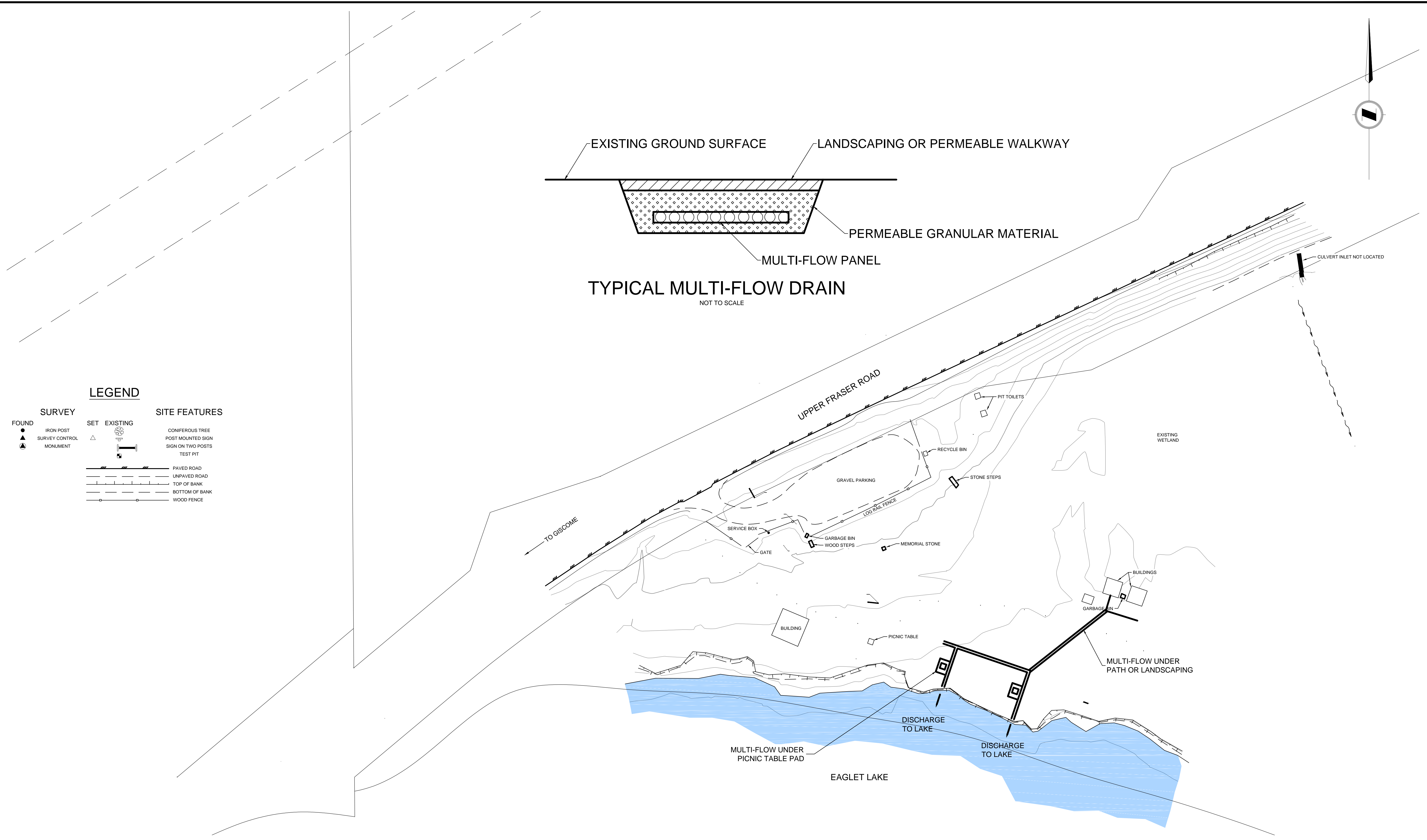

TYPICAL MULTI-FLOW DRAIN

NOT TO SCALE

LEGEND

SURVEY		SITE FEATURES	
●	FOUND IRON POST	△	SET CONIFEROUS TREE
▲	FOUND SURVEY CONTROL MONUMENT	□	EXISTING POST MOUNTED SIGN
		□	EXISTING SIGN ON TWO POSTS
		□	EXISTING TEST PIT
		—	PAVED ROAD
		—	UNPAVED ROAD
		—	TOP OF BANK
		—	BOTTOM OF BANK
		—	WOOD FENCE

THIS DRAWING AND DESIGN IS THE PROPERTY OF MCELHANEY CONSULTING SERVICES LTD. (MCELHANEY) AND SHALL NOT BE USED, REUSED OR REPRODUCED WITHOUT THE CONSENT OF MCELHANEY. MCELHANEY WILL NOT BE HELD RESPONSIBLE FOR THE IMPROPER OR UNAUTHORIZED USE OF THIS DRAWING AND DESIGN. THIS DRAWING AND DESIGN HAS BEEN PREPARED FOR THE CLIENT IDENTIFIED, TO MEET THE STANDARDS AND REQUIREMENTS OF THE APPLICABLE PUBLIC AGENCIES AT THE TIME OF PREPARATION. MCELHANEY, ITS EMPLOYEES, SUBCONSULTANTS AND AGENTS WILL NOT BE LIABLE FOR ANY LOSSES OR OTHER CONSEQUENCES RESULTING FROM THE USE OR RELIANCE UPON, OR ANY CHANGES MADE TO, THIS DRAWING BY ANY THIRD PARTY, INCLUDING CONTRACTORS, SUPPLIERS, CONSULTANTS AND STAKEHOLDERS, OR THEIR EMPLOYEES OR AGENTS, WITHOUT MCELHANEY'S PRIOR WRITTEN CONSENT. INFORMATION ON EXISTING UNDERGROUND FACILITIES MAY NOT BE COMPLETE OR ACCURATE. MCELHANEY, ITS EMPLOYEES AND DIRECTORS ARE NOT RESPONSIBLE NOR LIABLE FOR THE LOCATION OF ANY UNDERGROUND CONDUITS, PIPES, CABLES OR OTHER FACILITIES WHETHER SHOWN OR OMITTED FROM THIS PLAN. PRIOR TO CONSTRUCTION CONTRACTOR SHALL EXPOSE LOCATIONS OF ALL EXISTING FACILITIES BY HAND DIGGING OR HYDROVAC AND ADVISE THE ENGINEER OF POTENTIAL CONFLICTS.

ORIGINAL DWG SIZE: ANSI D (22" x 34")



McElhanney
McElhanney Consulting Services Ltd.

Suite 12
556 North Nechako Road
Princo George BC
Canada V2K 1A1
Tel 250 561 2229

REGIONAL DISTRICT OF FRASER - FORT GEORGE
155 GEORGE STREET, PRINCE GEORGE, BC, V2L 1P8

HAROLD MANN REGIONAL PARK
MULTI-FLOW DRAIN CONCEPT

Drawing No.
SK-1

Project Number
2341-02214-00

Rev.
A

Rev	Date	Description	Drawn	Design	App'd
0	16-10-25	FOR REVIEW	SAB	-	DK