



Addendum No. 1

Invitation to Tender – ES-16-19

LANDFILL GAS MAIN HEADER EXTENSION AND PERIMETER ROAD CONSTRUCTION

The addendum is being issued prior to the closing of the ITT to provide further information, make changes to, or to clarify the Contract Documents and is to be read, interpreted and coordinated with all other parts of the Contract Documents. In the case of a conflict with the balance of the documents, this Addendum shall govern. **Tenderers shall acknowledge receipt of this Addendum on the Tender Form and shall attach a signed copy of this addendum to their Tender Submission.** This addendum shall form part of the Contract Documents.

1: Please find attached a revised copy of drawings - Sheet C-03.

This addendum was issued in order to show the correct distances in relation to the corresponding grades.

July 27, 2016

Signature

Name:

Inquiries relating to this ITT may be directed to:

Darwin Paton
Environmental Services Technician
Regional District of Fraser-Fort George
155 George Street
Prince George, BC V2L 1P8
Phone: 250-960-4400 / Fax: 250-526-8676
Email: dpaton@rdffg.bc.ca

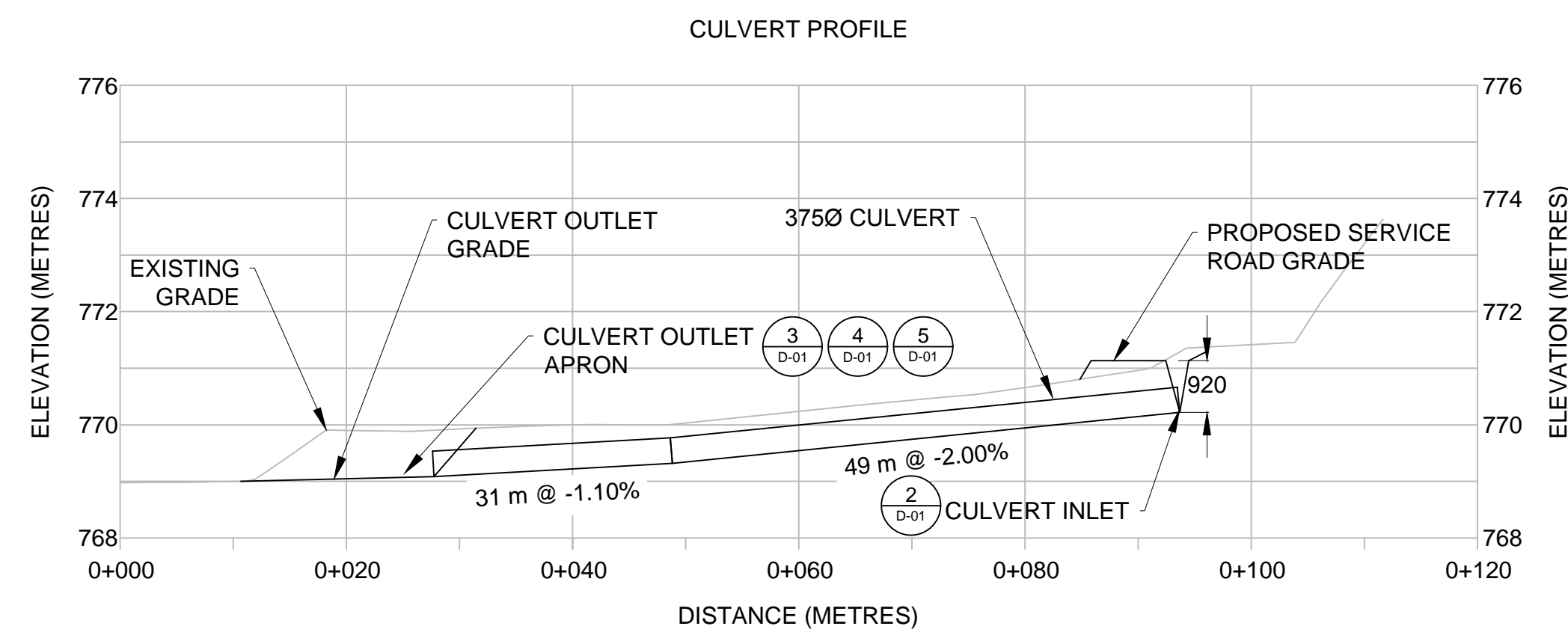
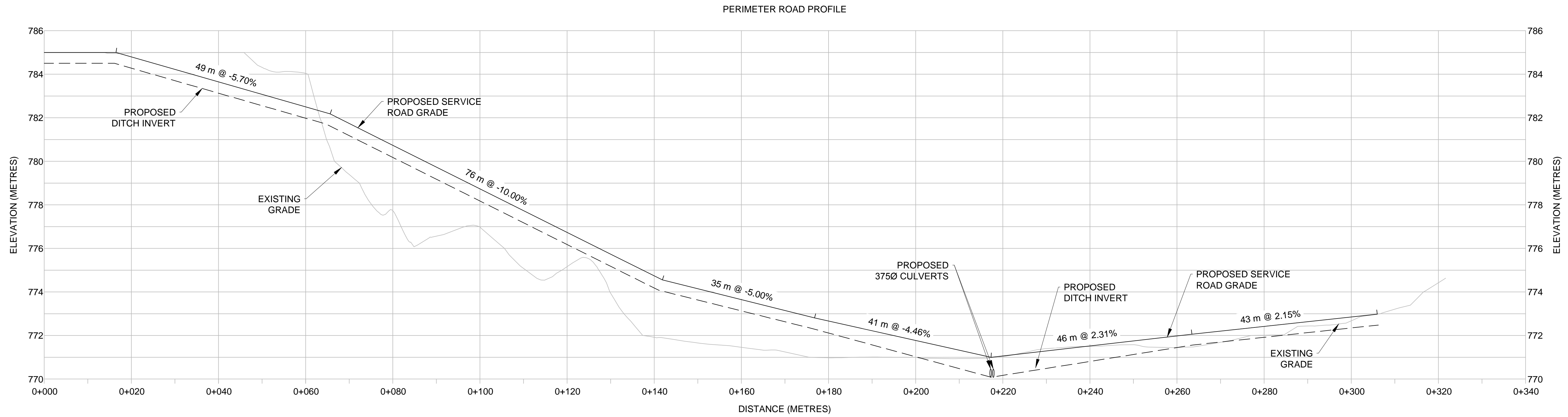

NOTE: ALL UNITS IN MILLIMETRES UNLESS OTHERWISE NOTED.

REVISIONS			
REV	DESCRIPTION	DATE	APPROVED
0	ISSUED FOR REVIEW	JUNE 2016	M. LEFEBVRE
1	ISSUED FOR REVIEW	JUNE 2016	M. LEFEBVRE
2	ISSUED FOR TENDER	JULY 2016	M. LEFEBVRE
3	ISSUED FOR TENDER	JULY 2016	M. LEFEBVRE

LFG MAIN HEADER EXTENSION AND PERIMETER ROAD

FOOTHILLS BOULEVARD REGIONAL LANDFILL

REGIONAL DISTRICT OF FRASER-FORT GEORGE

(file: TND24280160001C03.DWG)

VERIFY SCALE
BAR IS 20 mm ON ORIGINAL DRAWING.
0 20 mm
IF NOT 20 mm ON THIS SHEET, ADJUST SCALES ACCORDINGLY.

PERIMETER ROAD AND CULVERT PROFILES

Date:	Location:	Rev:
JULY 2016	PRINCE GEORGE, B.C.	3
Scale: 1:500H 1:100V	4-2428-01-60	Sheet: C-03